

TIMKEN**The Timken Company**

4500 Mt Pleasant St. NW

N. Canton, OH 44720

Phone: (234) 262-3000

E-Mail: CustomerCAD@timken.com • Web site: www.timken.com

Part Number 61830, Thin Section Ball Bearings (61700, 61800, 61900)

Timken's deep groove ball bearings deliver reliable performance in a wide range of applications and conditions. With super-finished raceways and controlled geometries, our premium design helps ensure consistent quality.

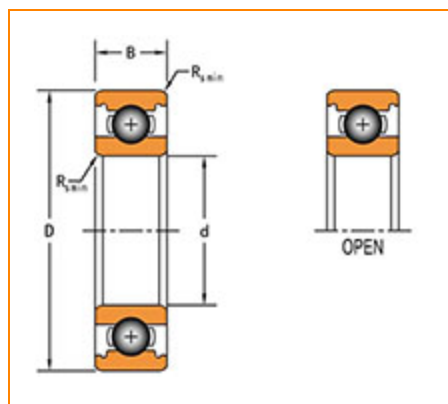

[Specifications](#) | [Dimensions](#) | [Basic Load Ratings](#) | [Factors](#)

Specifications

Clearance	C0 (Normal)
Bore Size d	150.000 mm
Features	Open
Weight	1.170 Kg

Dimensions

Outside Diameter D	190.000 mm
Outside Ring Width B	20.000 mm
Radius R_s min	1.100 mm



Basic Load Ratings

Cr - Dynamic Load Rating 49.1 kN

C0r - Static Load Rating 57.1 kN

Factors

Grease Limiting Speed 3000 rpm

Oil Limiting Speed 4500 rpm

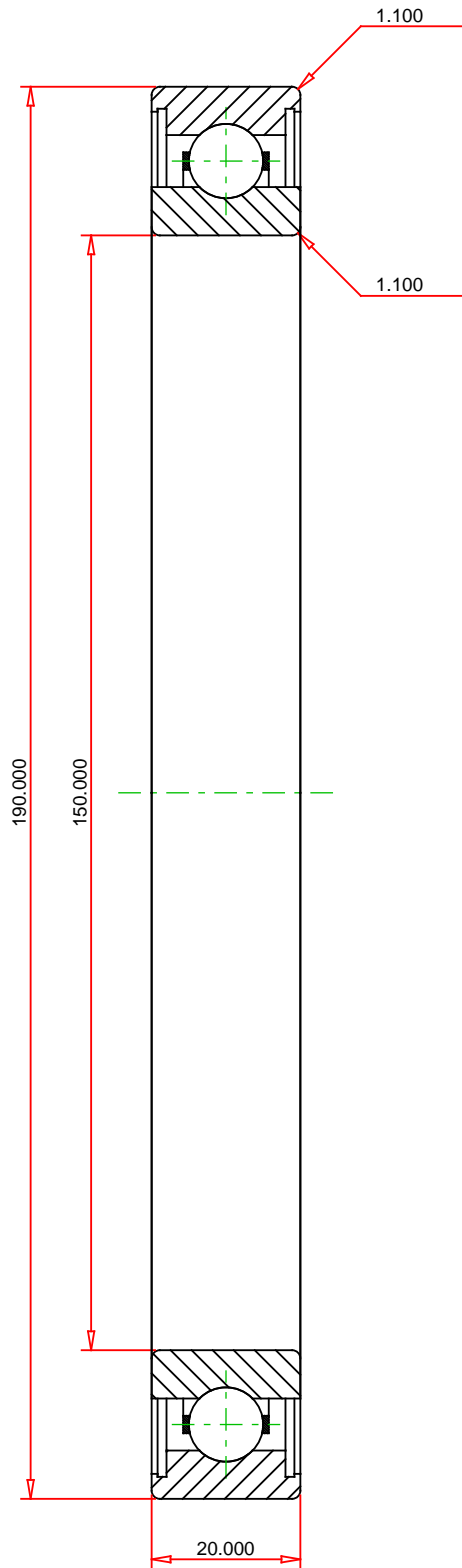

METRIC UNITS

Weight 1.17 kg

TIMKEN®

THE TIMKEN COMPANY
NORTH CANTON, OHIO USA

61830
Thin Section Ball Bearings (61700, 61800, 61900)

Dynamic Load Rating 49100 N
Static Load Rating 57100 N

Every reasonable effort has been made to ensure the accuracy of the information contained in this writing, but no liability is accepted for errors, omissions or for any other reason.

FOR DISCUSSION ONLY